

Kazan

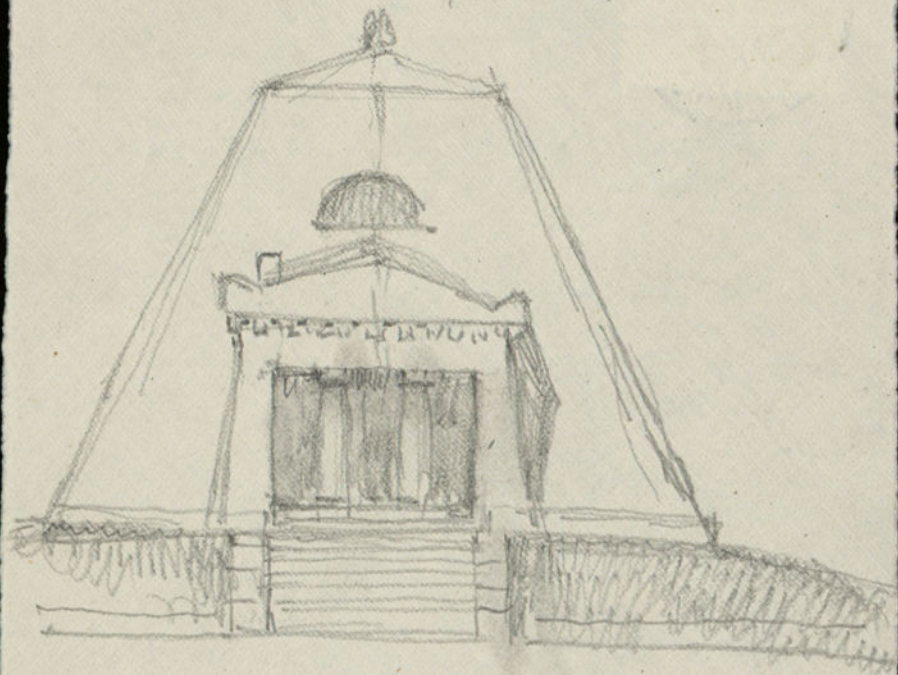



Sr.

D. Juan Moya y Ira

Modesto Lafuente 12

Madrid

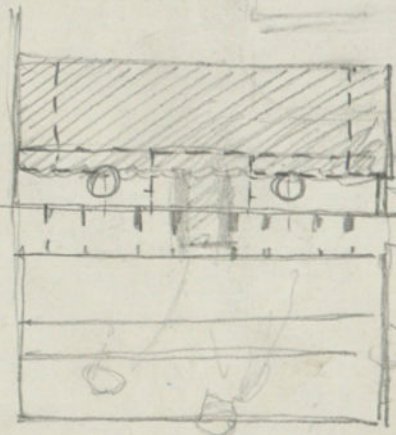



MADRID
Tipografía de Archivos
Olózaga, núm. 1
1935

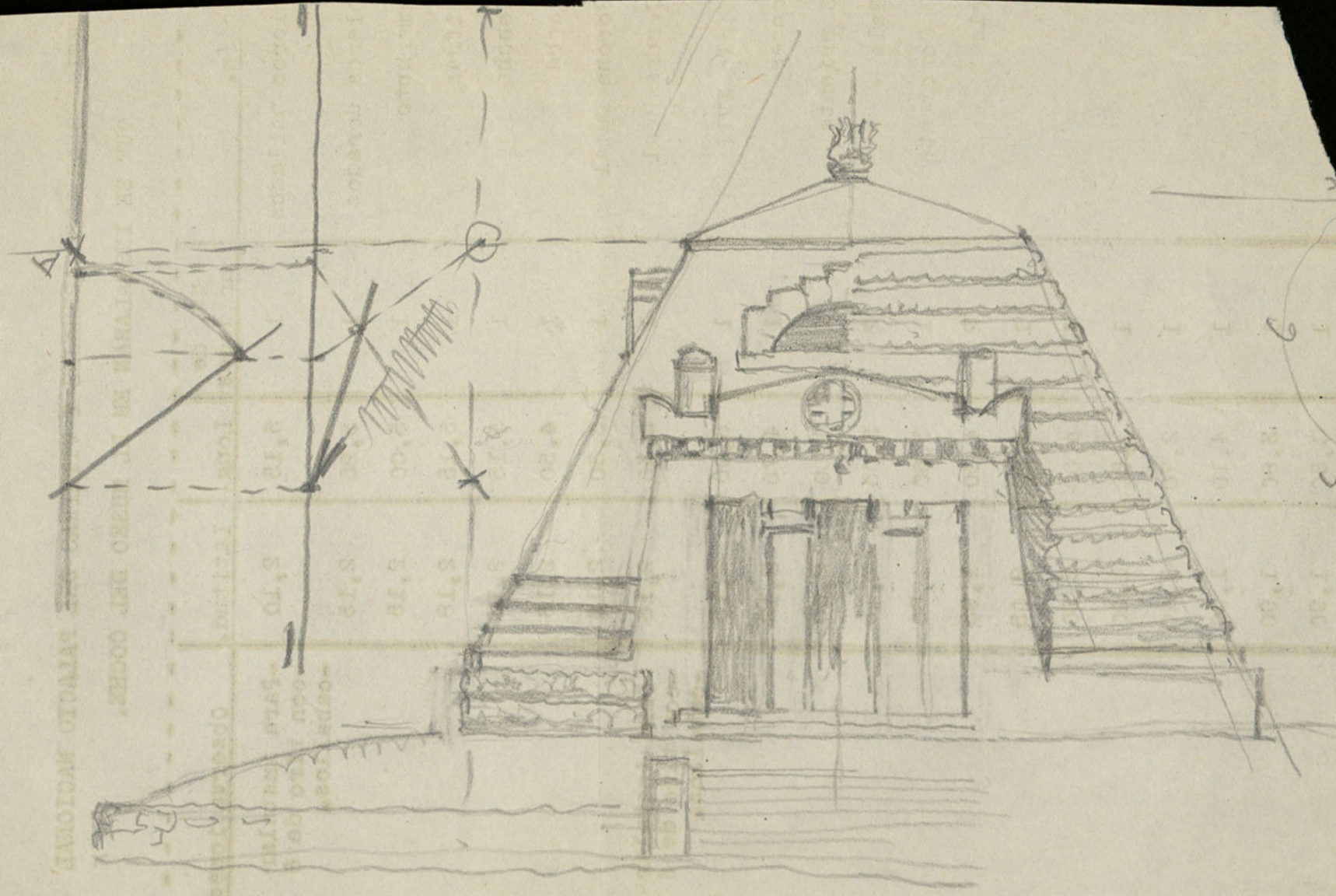

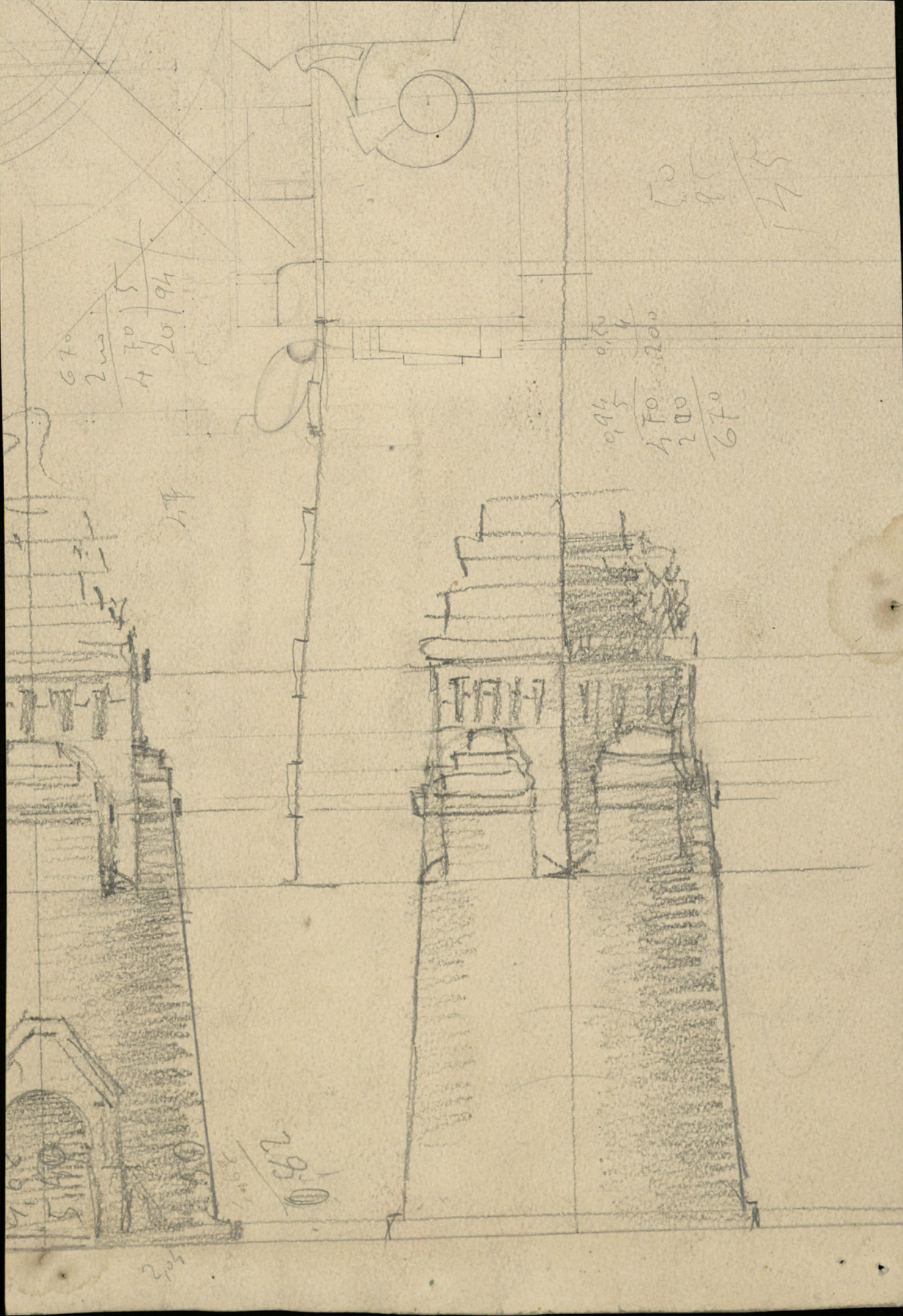

670
200
4
70
20
94

670
94
175

94
170
200
670

295
147

204

Medida de 0,76

2

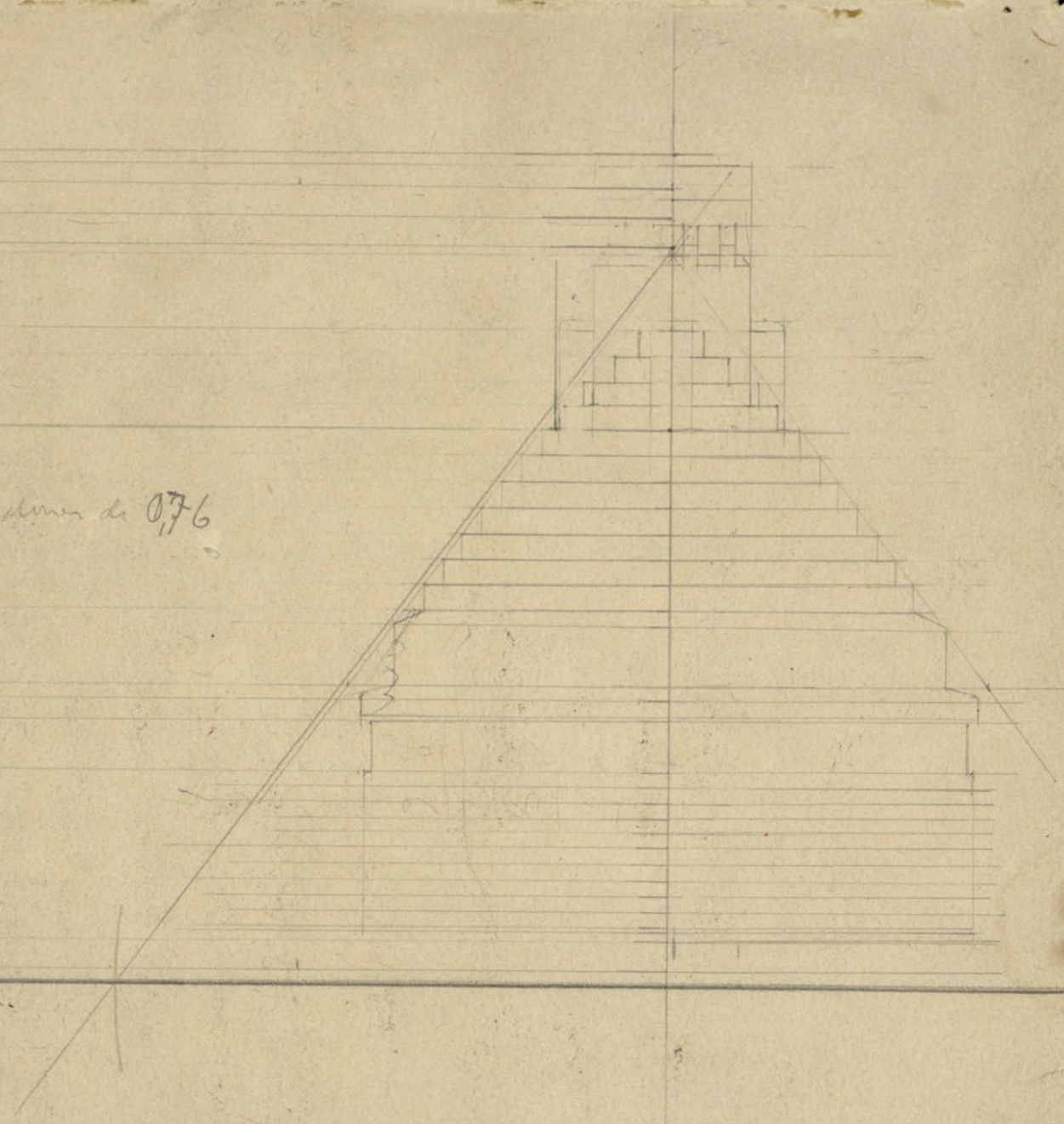

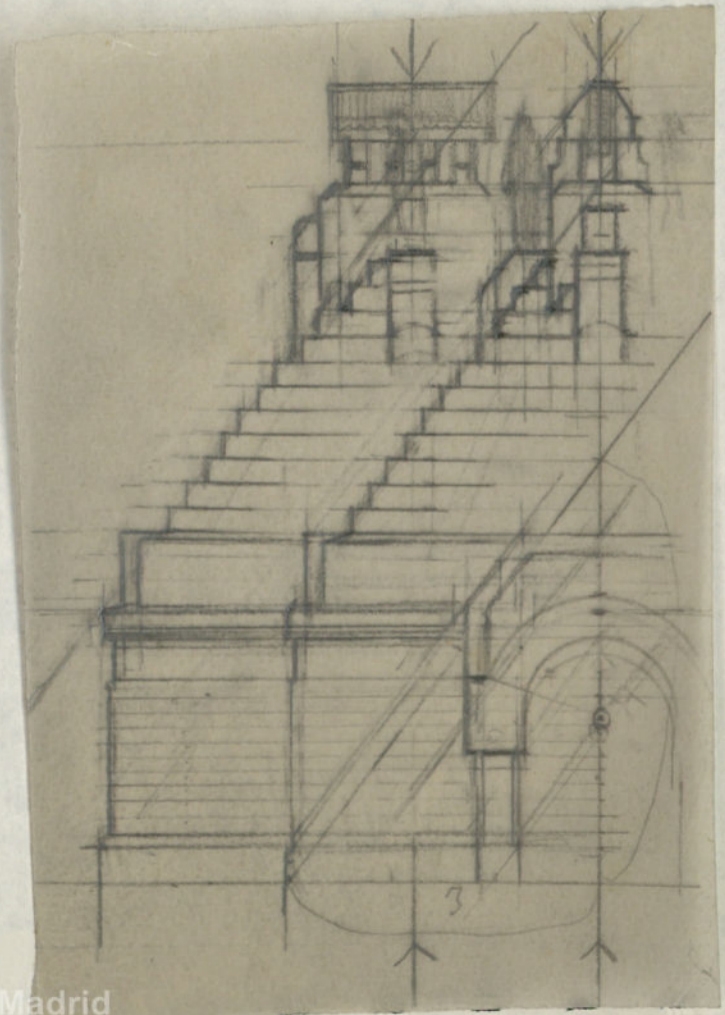
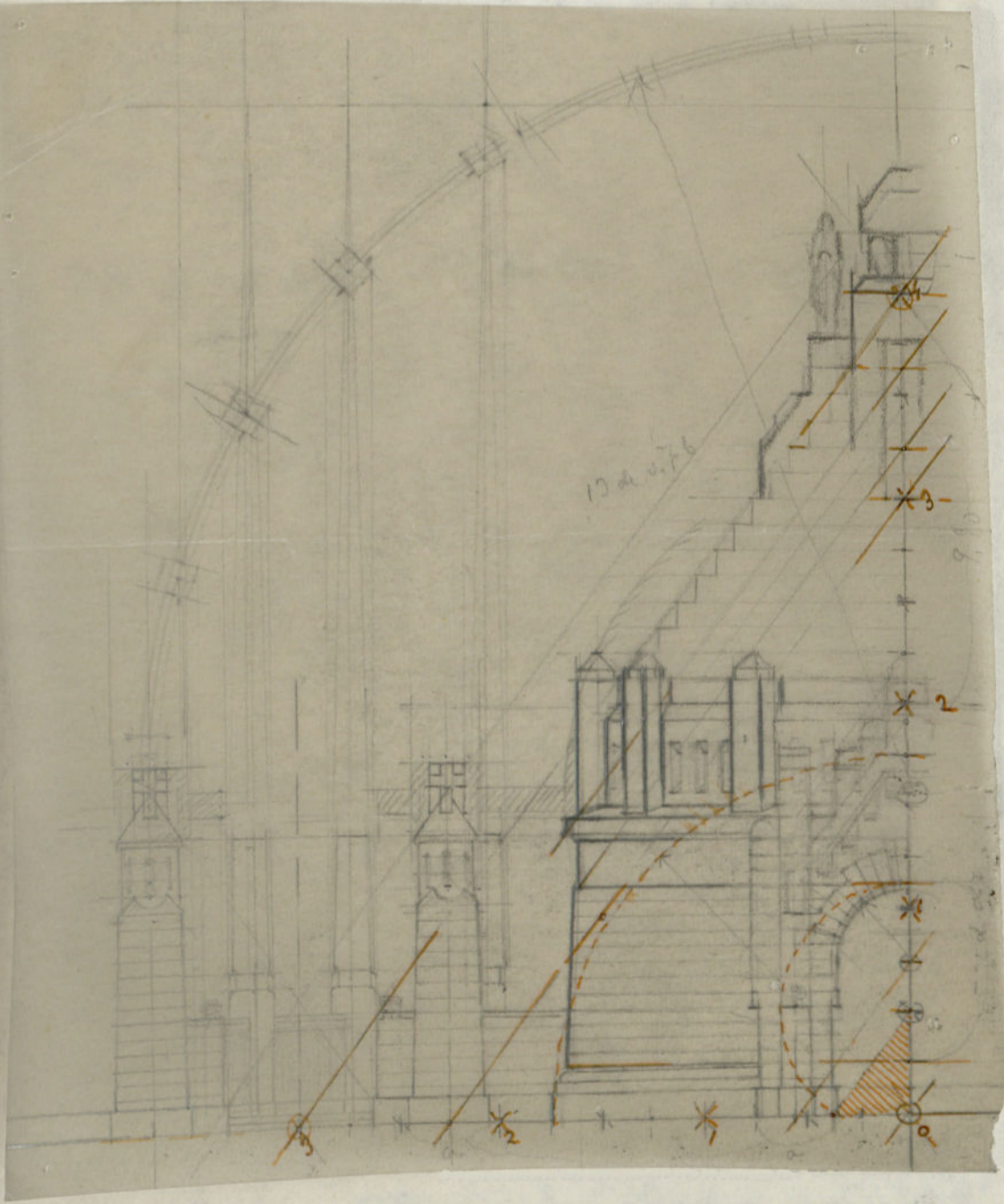
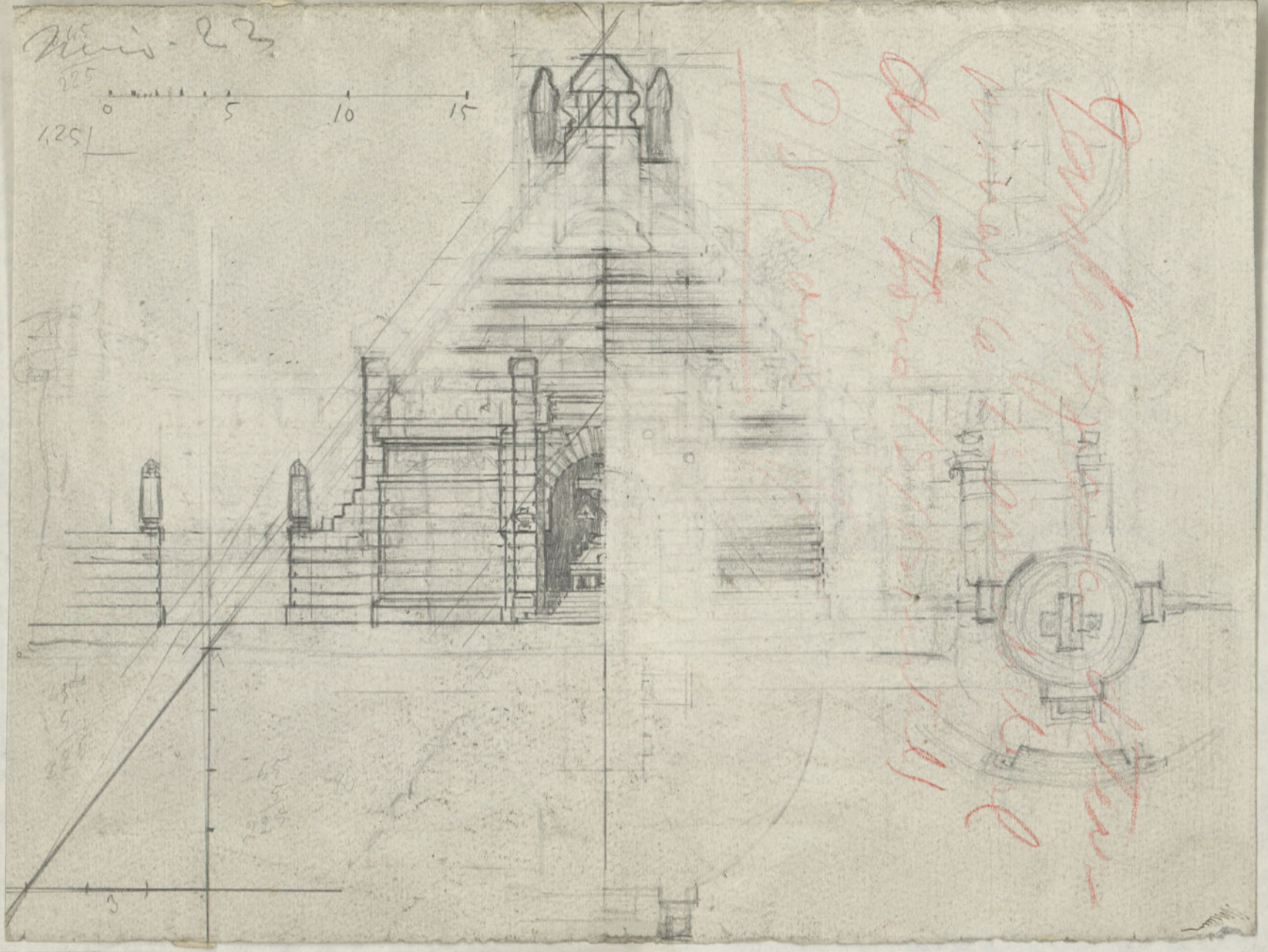

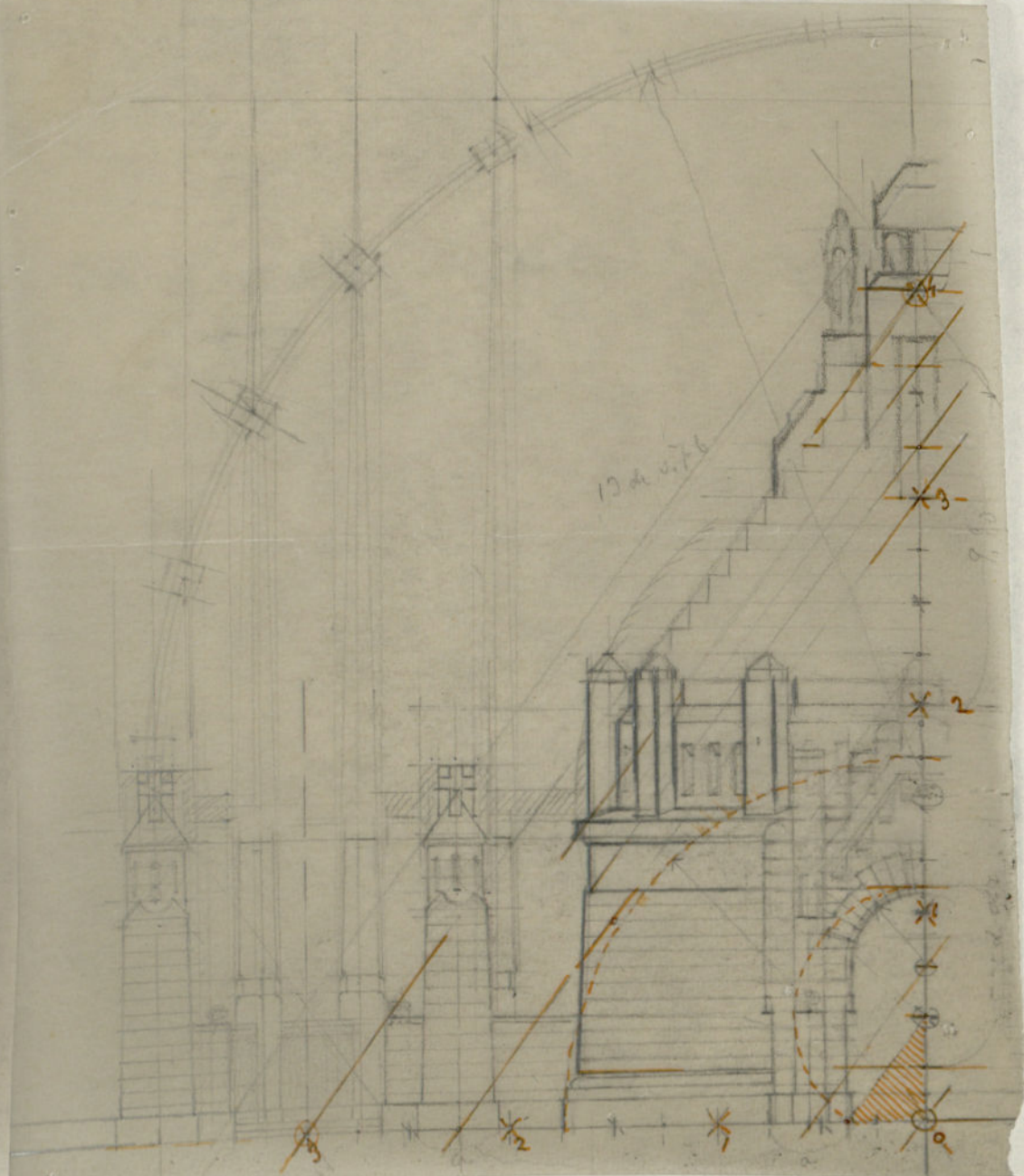

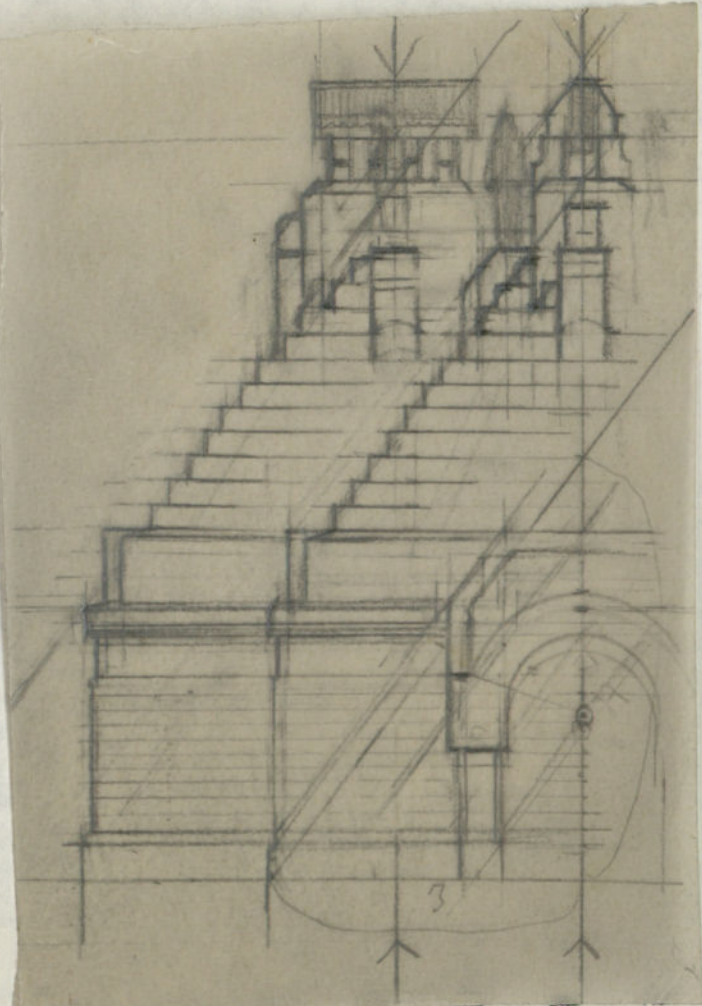

Detalle de detalles 0,07

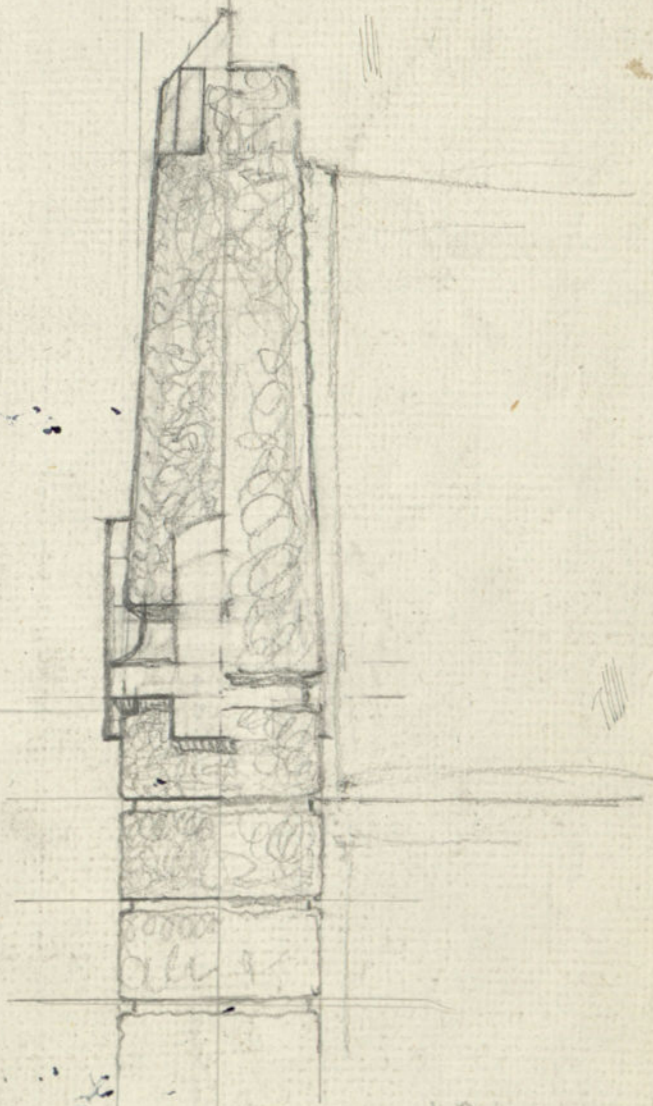

8,75
96,25
76,5
168,0
9,75
71,25

22 - 22

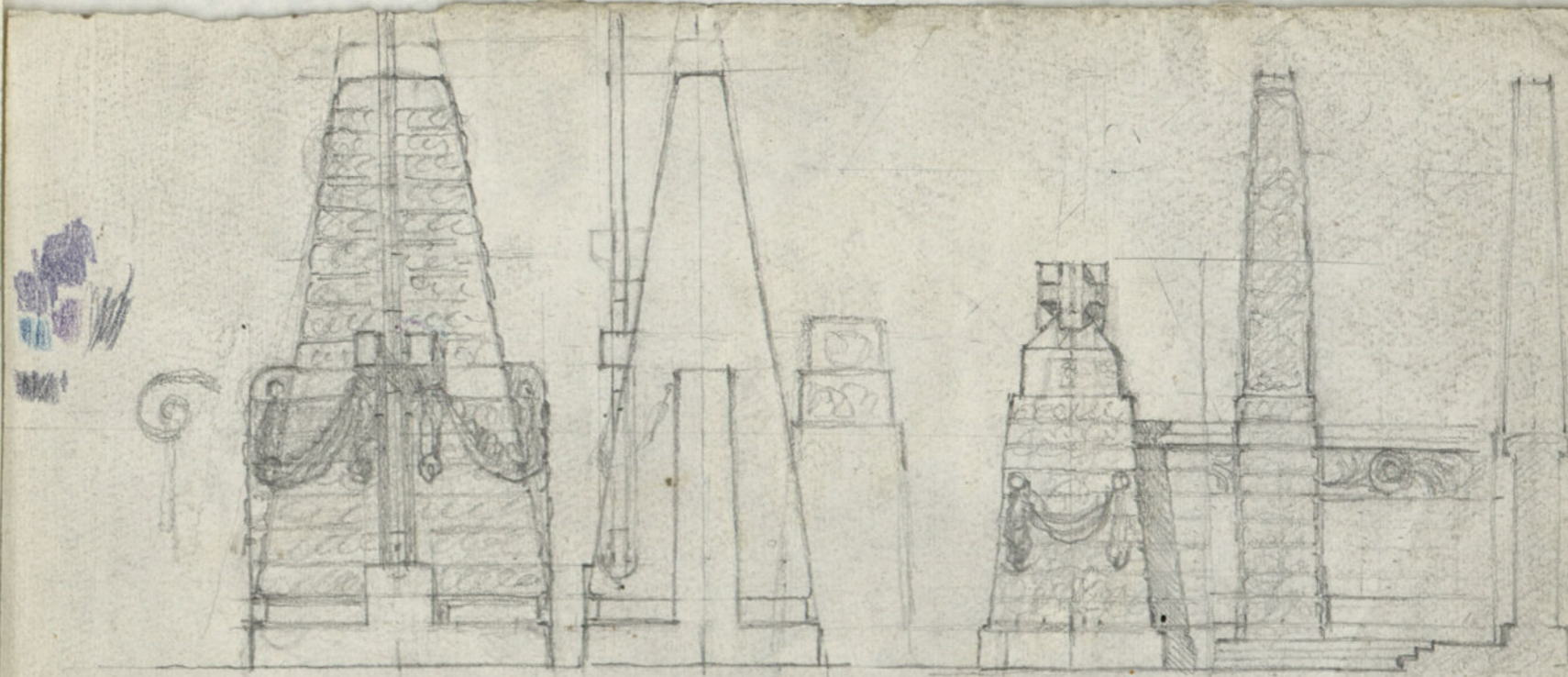

AMC

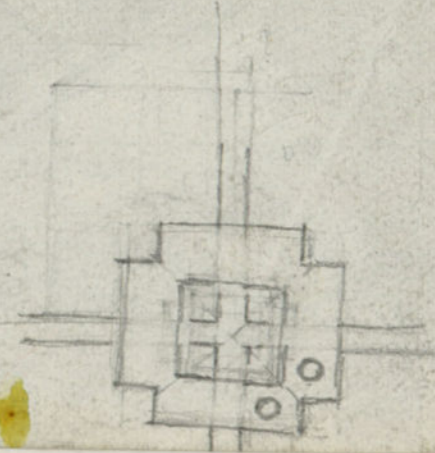

Costo de detalles 0,07



0,90

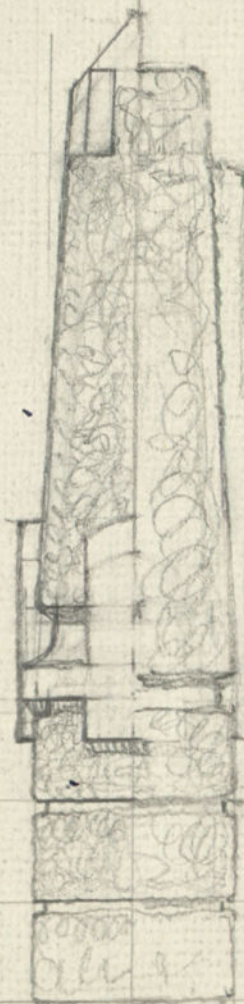

8,75
3
16,80
7,80
11,25
0,75

22 - 22

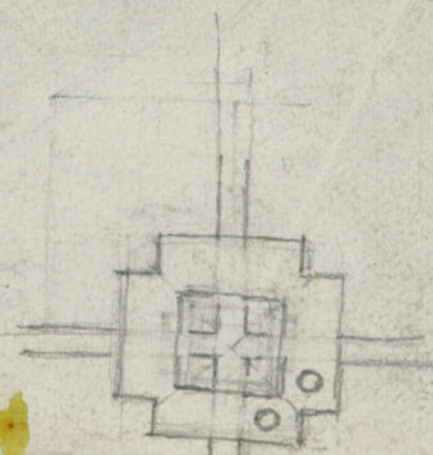
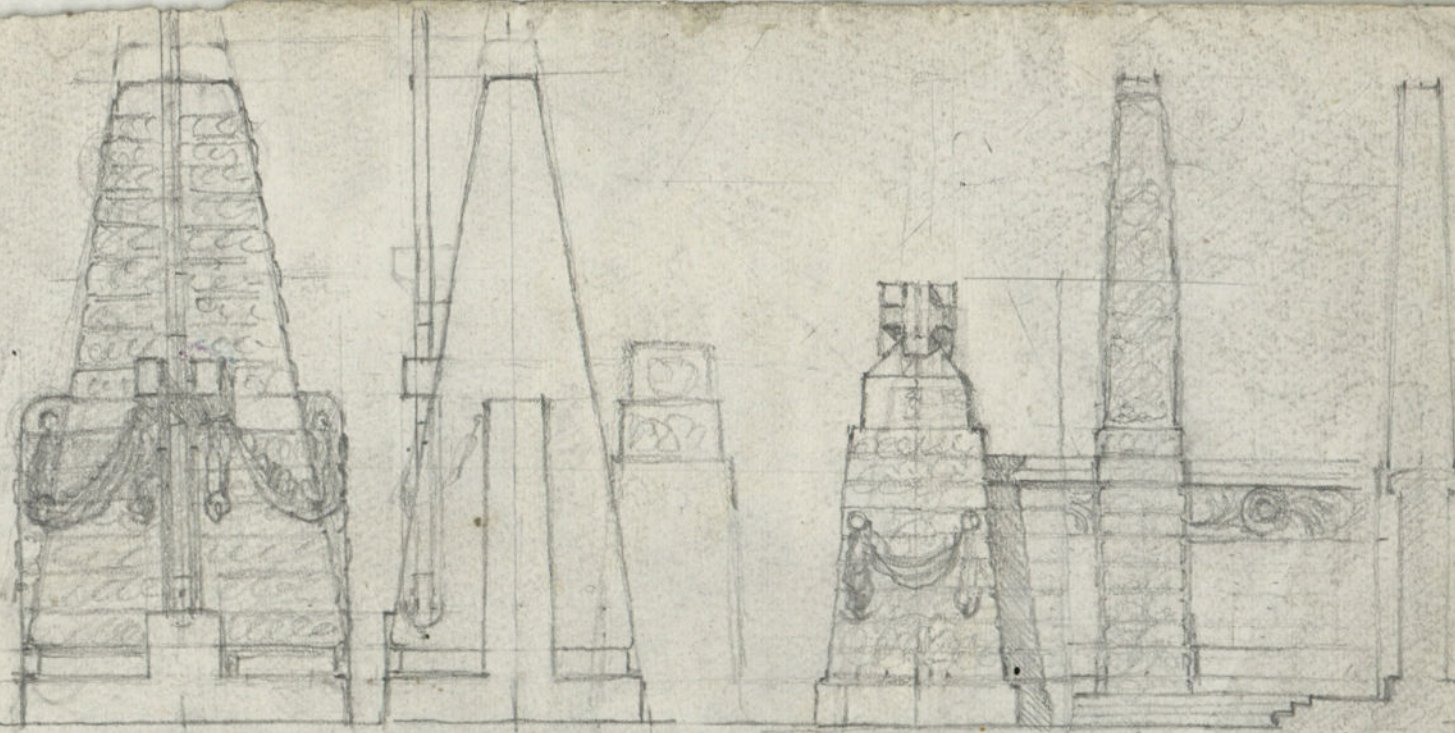

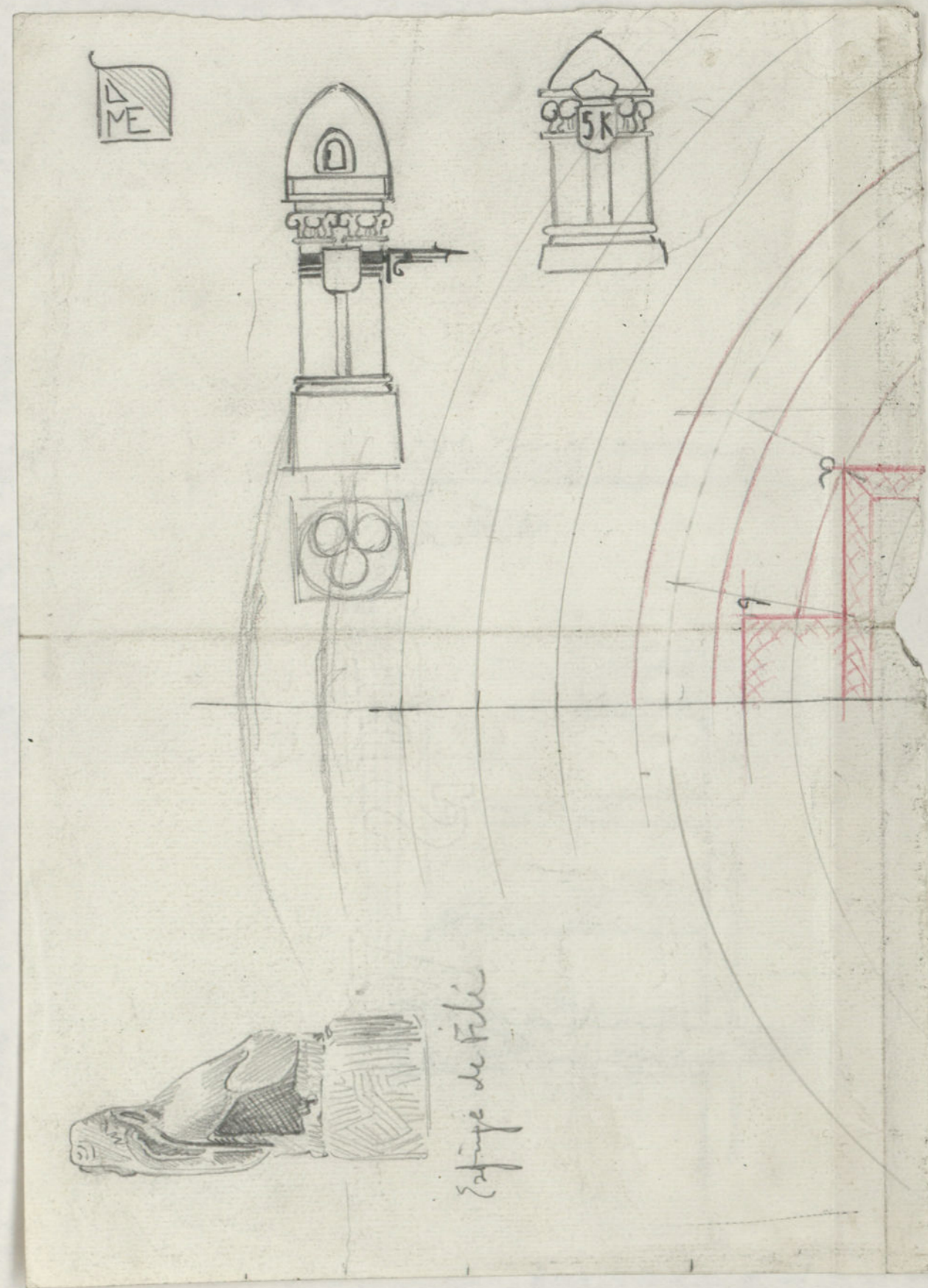



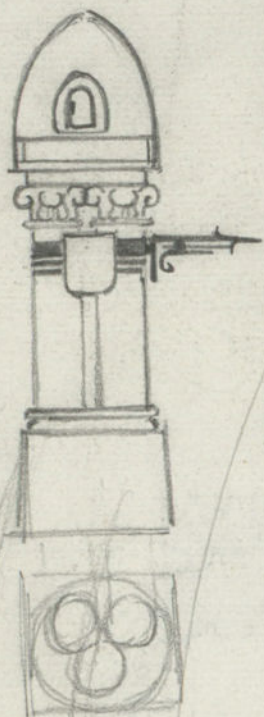

Espejo de Filé

IN MEMORIAM
MARTYRUM
SCELERIS MARXISTE

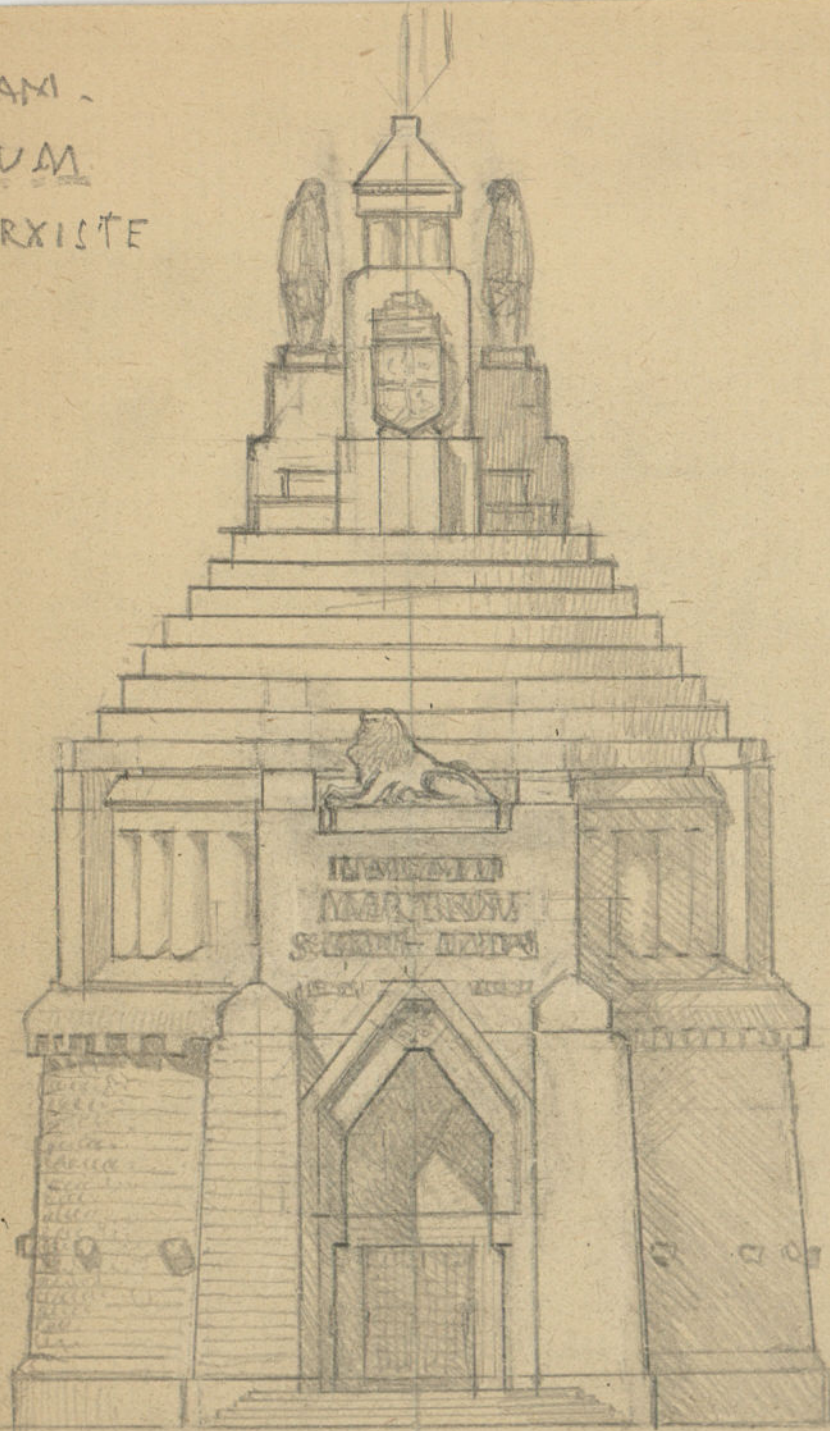
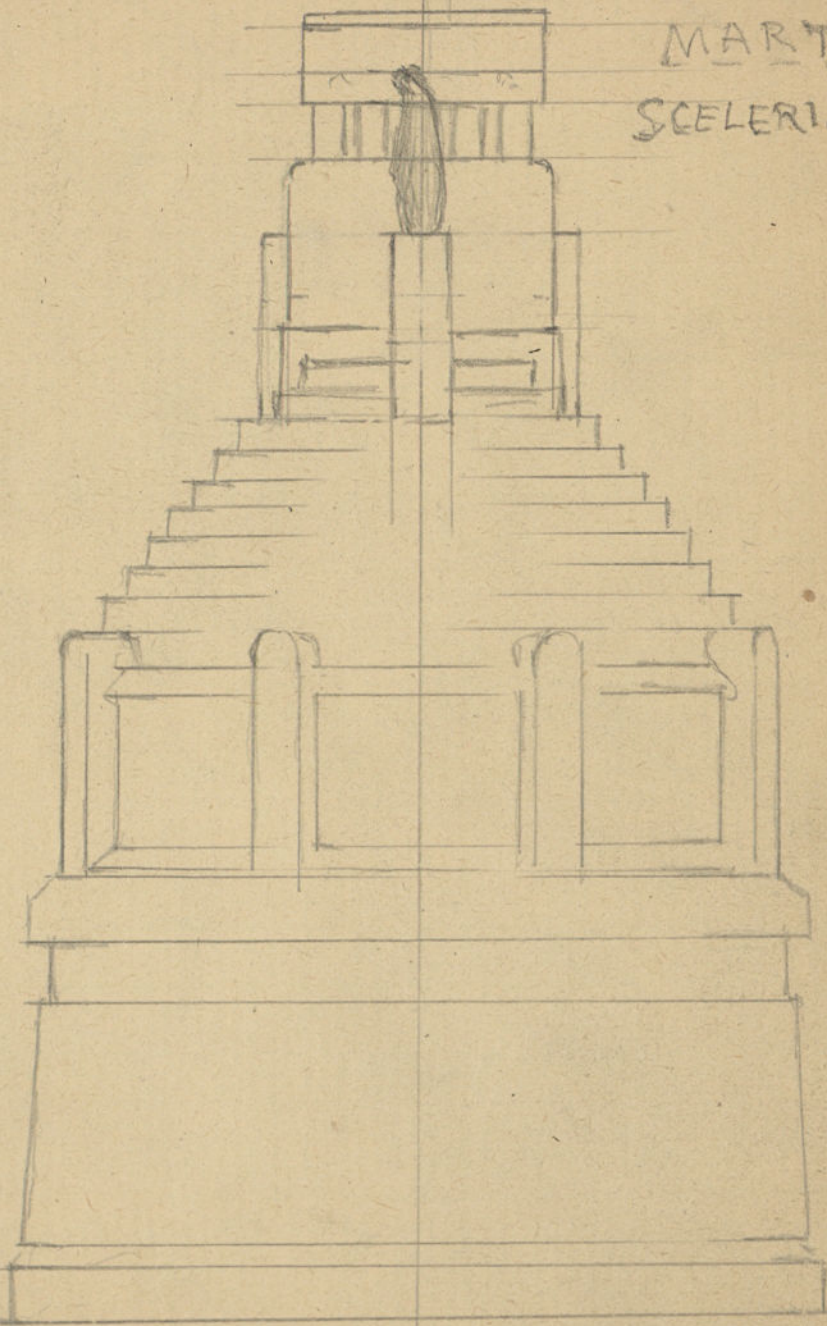

Plano de los huecos de Africa

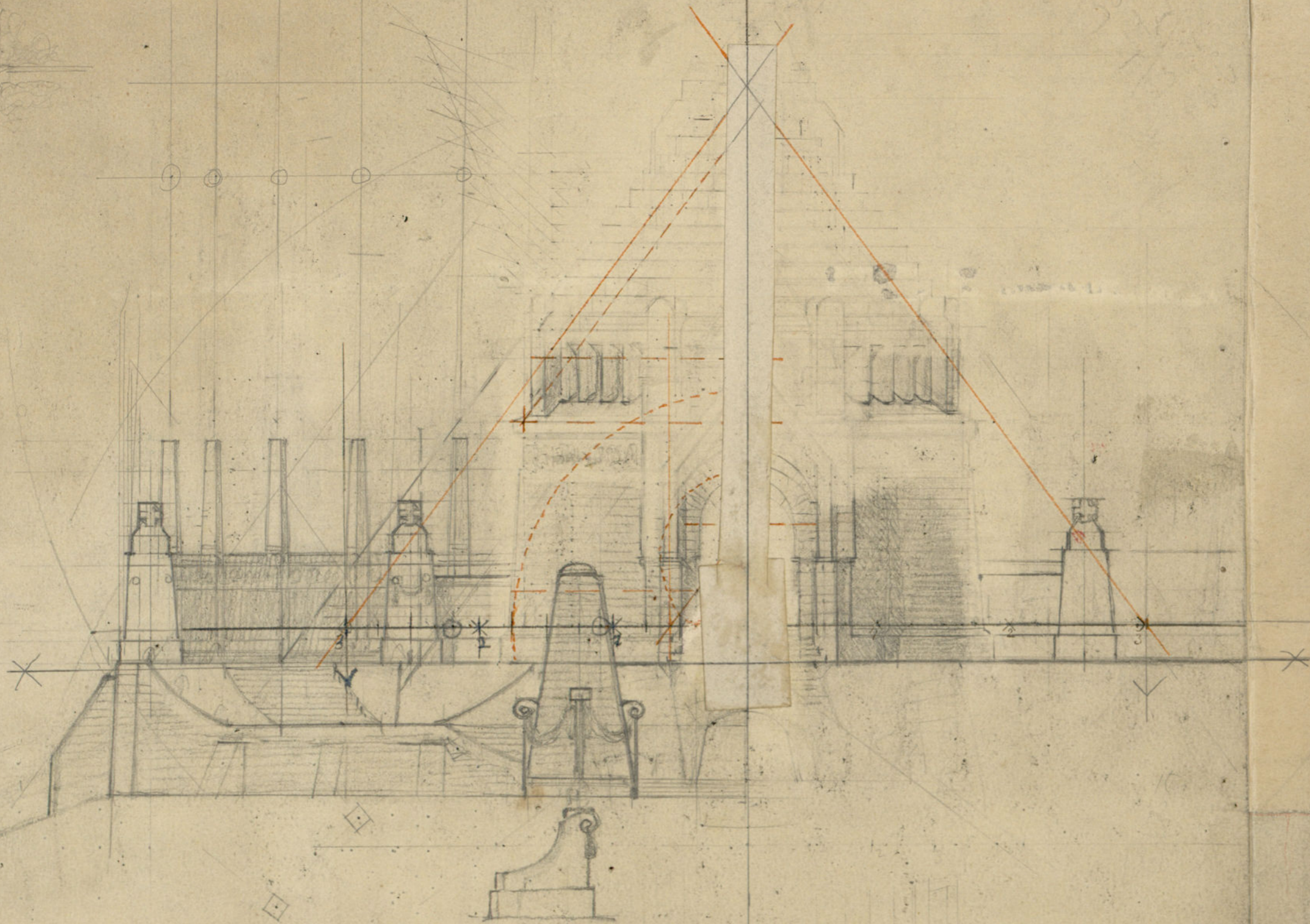

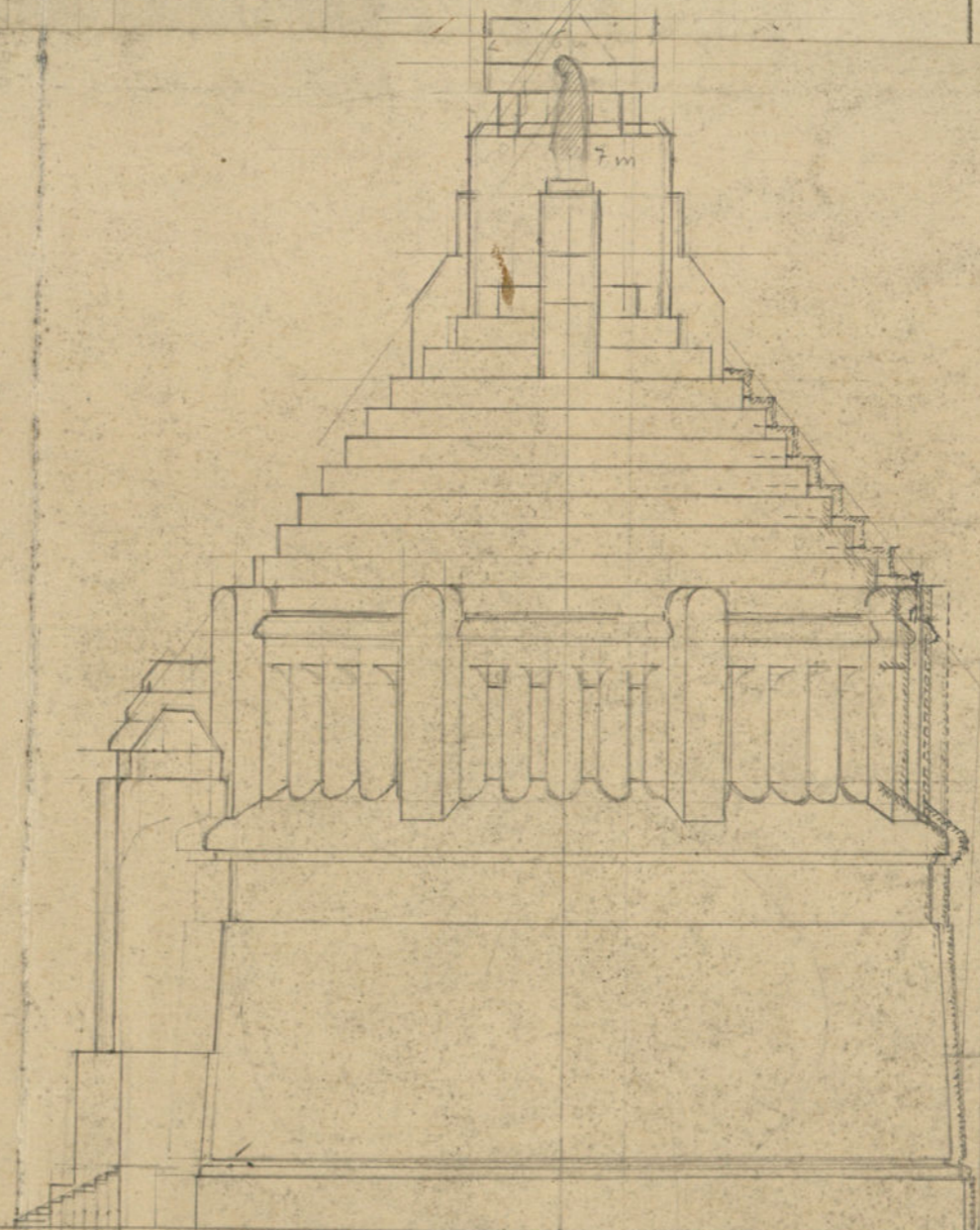

Porta

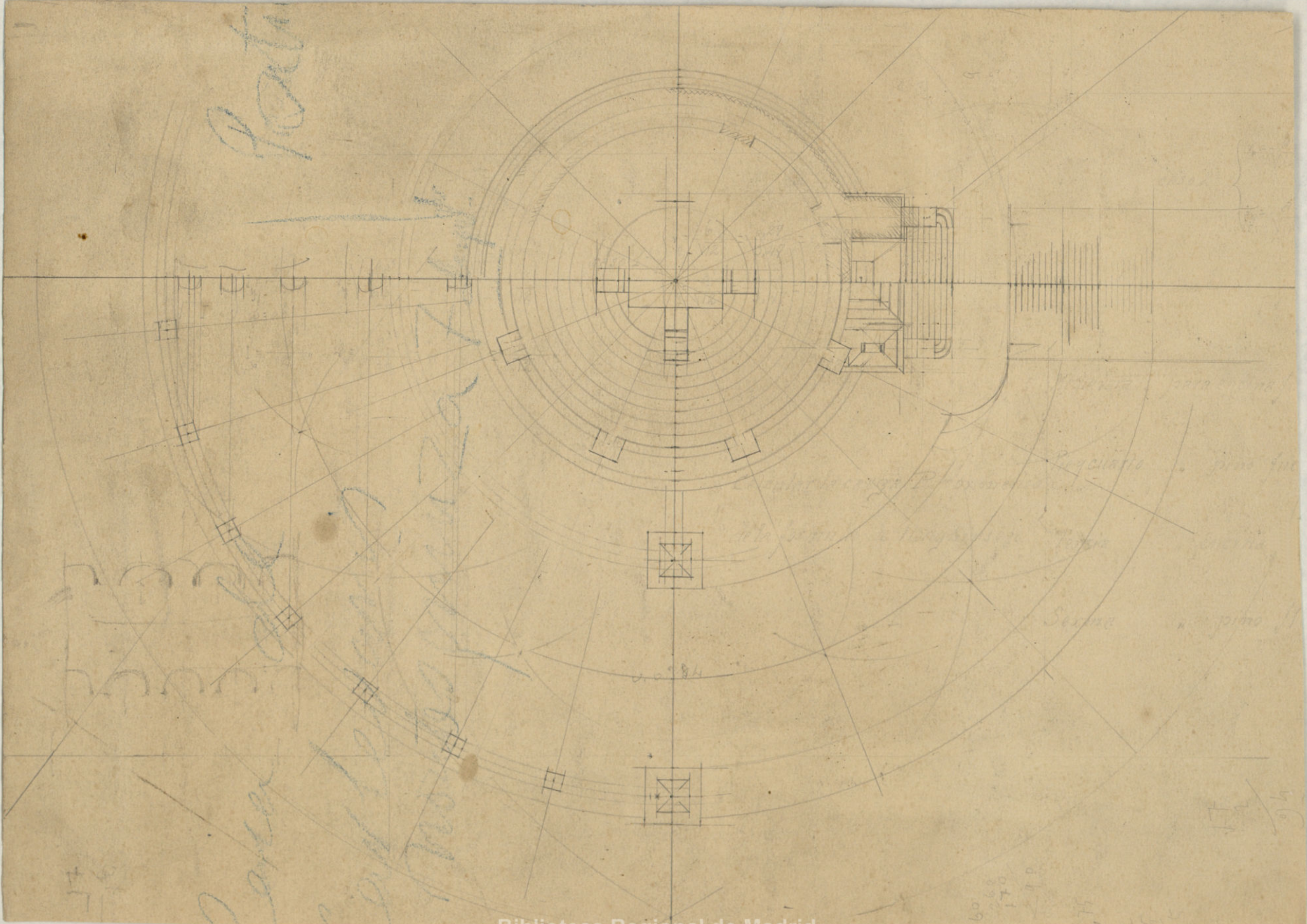

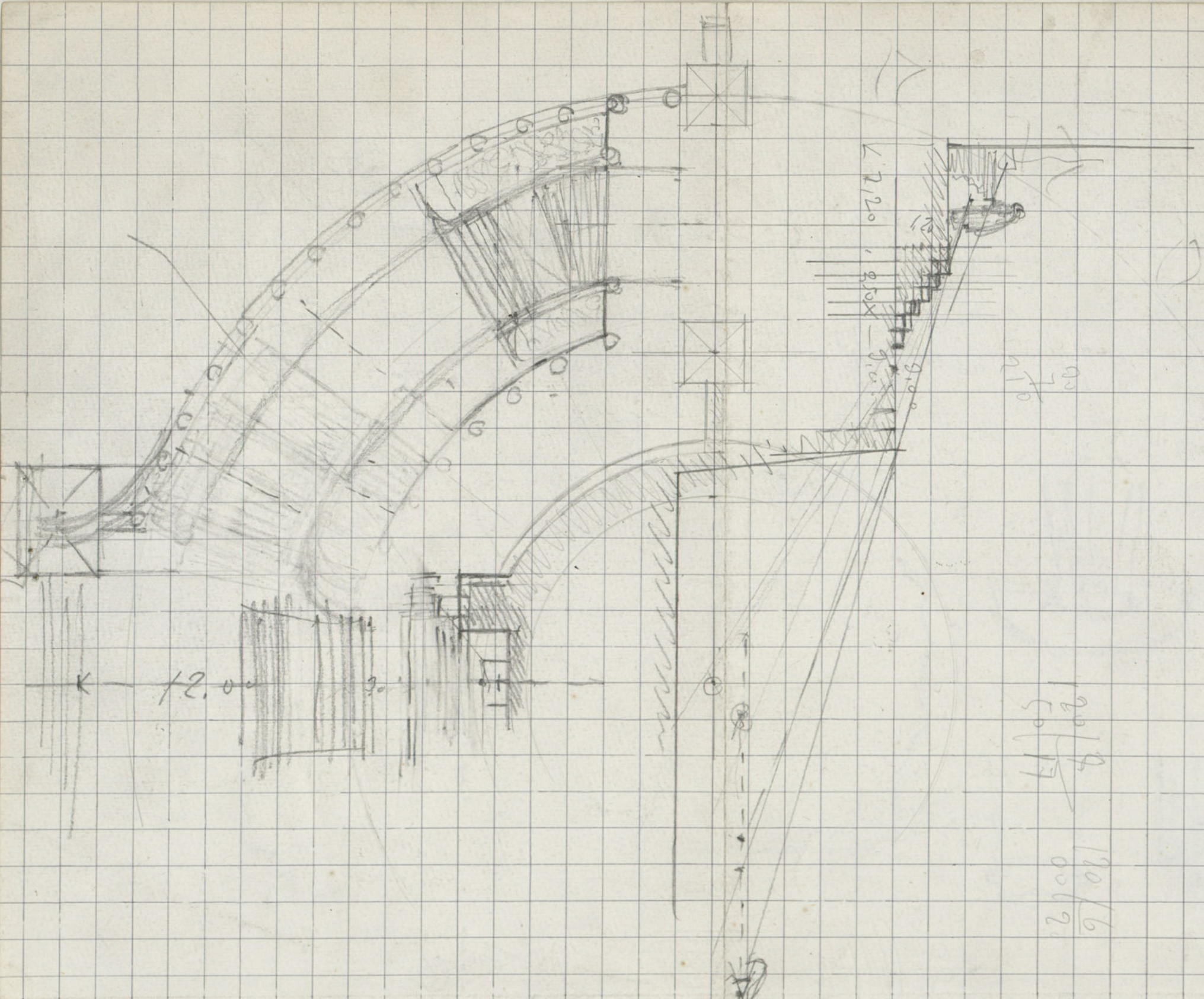

Plano 22 162

~~Detalle~~
su interior de
1913 a 1914

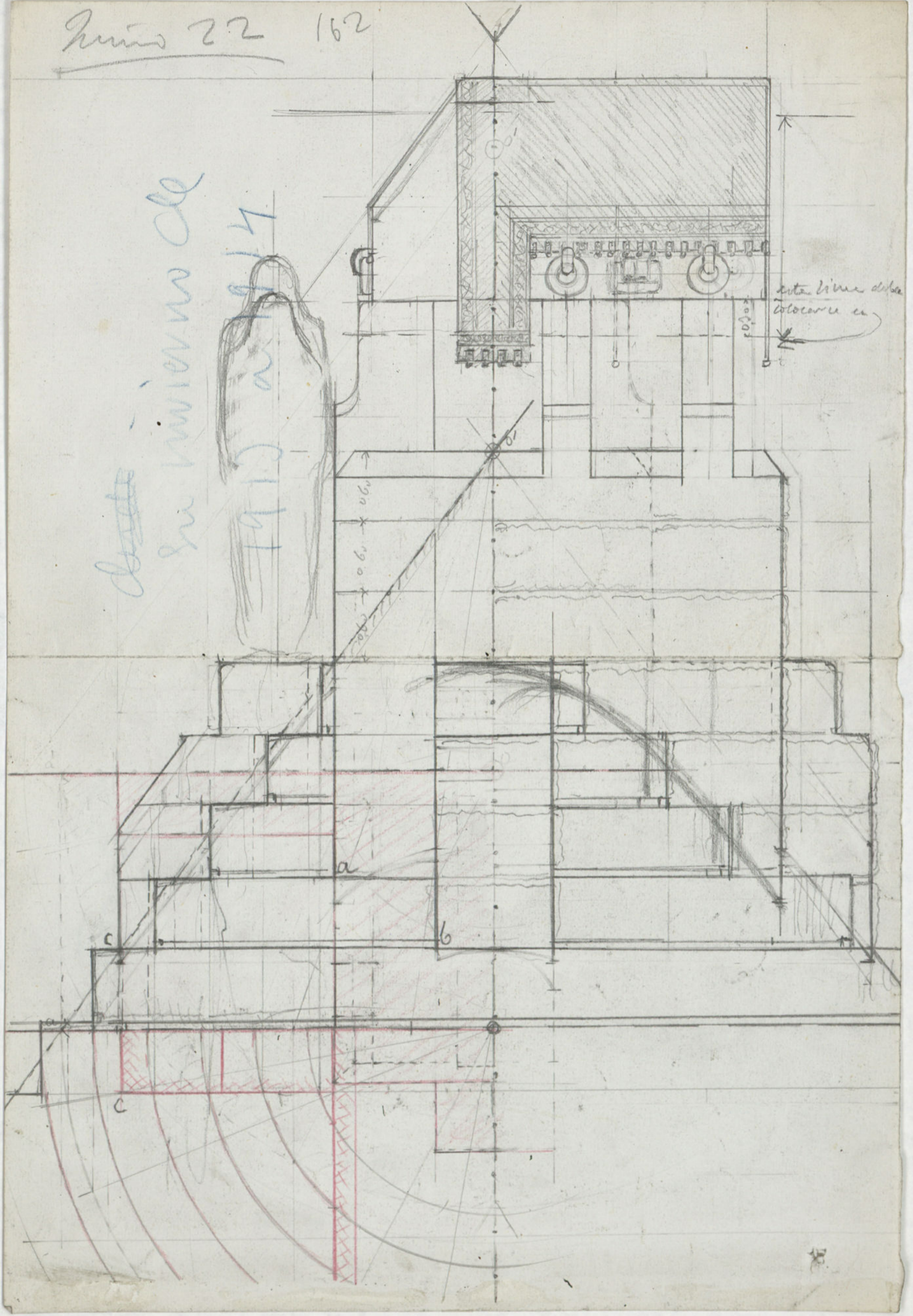

esta línea debe
colocarse en

Bocetos y estudios para un hospital
monumental a los Nervios de la Guinea de Africa

En 11 folios con diferentes dibujos

~~para este~~

~~del desarrollo de esta idea~~

que desarrollan inacabadamente

este proyecto, sin poder precisar si la

idea partió de su primer encuentro, o

seguíamente de un trabajo permanente

personal